



# ICE QUEEN IQ F 900

115 V / 60 Hz

**3 YEARS WARRANTY**  
PARTS & LABOR

## MODULAR FLAKE ICE MACHINE

### FEATURES

- ▶ PRODUCES FLAKE ICE
- ▶ HIGH EVAPORATOR EFFICIENCY: LOWER ENERGY CONSUMPTION AND HIGHER ICE PRODUCTION
- ▶ FRONT LED DISPLAY FOR QUICK DIAGNOSTICS
- ▶ I-CHECK SMART SYSTEM CONTROLS AND DETECTS PARAMETERS AND FAULTS
- ▶ ELECTRONIC CONTROL. ON/OFF LIGHTED SWITCH IN FRONT PANEL
- ▶ STAINLESS STEEL AUGER TO MAXIMIZE LIFESPAN
- ▶ POWERFUL GEAR MOTOR
- ▶ AISI 304 STAINLESS STEEL BODY
- ▶ OPTICAL PINPOINT CONTROL SYSTEM TO SET ICE STOCK LEVEL
- ▶ EASY ACCESS FOR SERVICE AND INSTALLATION



**!** THE INSTALLATION OF AN ANTI-SCALE FILTER AND PERIODIC CLEANING ARE RECOMMENDED IN AREAS WITH MEDIUM OR HIGH LIMESCALE CONTENT (HARD WATER)

- EASI**  
Easy Access for Service & Installation
- STIF**  
Strong Inox Frame
- FRONT VENTILATION**

	<b>lbs</b> 24 H	70°F/21°C   50°F/10°C	90°F/32°C   70°F/21°C	<b>in (mm)</b>	<b>in (mm)</b>
	<b>lbs (Kg)</b>	<b>lbs (Kg)</b>			
IQ F 900 A	<b>860 (390)</b>	<b>664 (301)</b>		Width <b>22"</b> (559) Depth <b>24.5"</b> (622) Height <b>28"</b> (712)	Width <b>25"</b> (636) Depth <b>27.4"</b> (695) Height <b>32.9"</b> (835)
IQ F 900 W	-	-			



### ACCESSORIES

NOT INCLUDED (OPTIONAL)



10" FILTER  
ANTI-LIMESCALE + ANTI-CHLORINE  
CS-101 K



10" REPLACEMENT CARTRIDGE  
ANTI-LIMESCALE + ANTI-CHLORINE  
CS10



SCALE KLEEN

### RECOMMENDED BINS



S400-22 + IQ F 900

S500 + IQ F 900

S750 + IQ F 900

S900 + IQ F 900

S1050 + IQ F 900

SCS350 + IQ F 900

SCS700 + IQ F 900

SCD900 + IQ F 900

SCD1400 + IQ F 900

SCD1800 + IQ F 900

# TECHNICAL SCHEME

## ICE QUEEN F 900

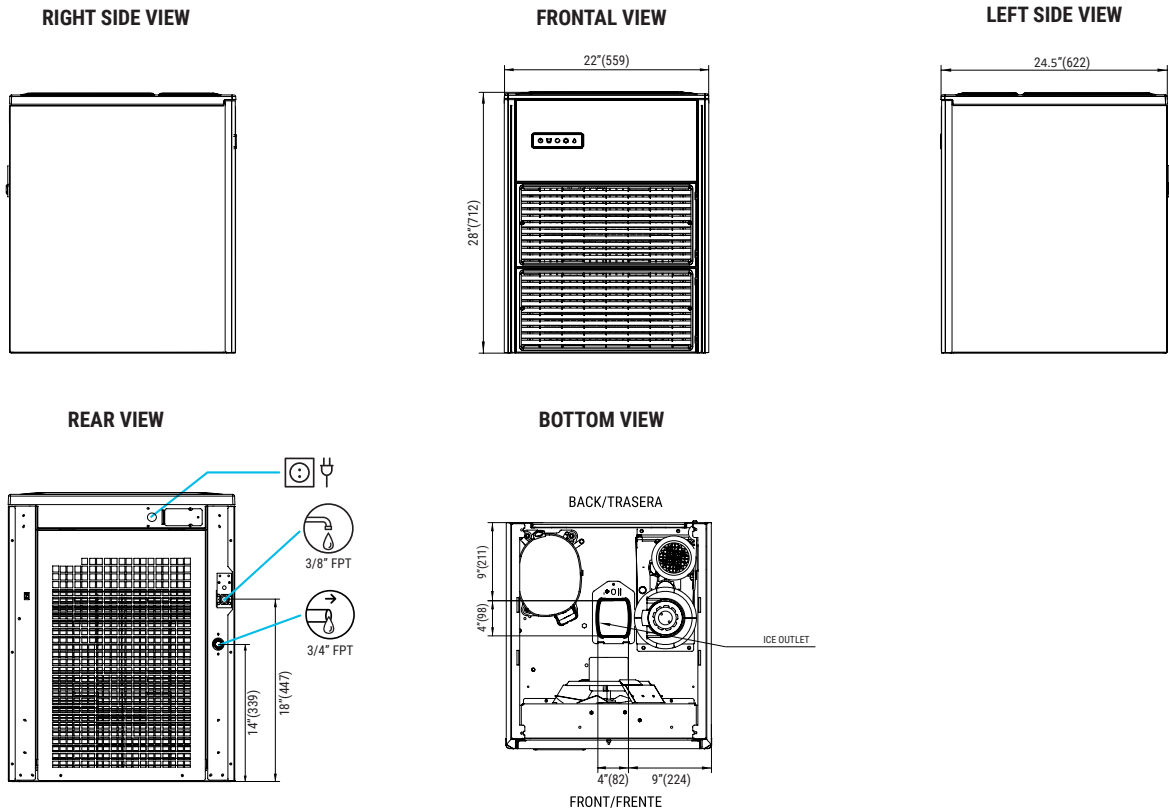

\* All dimensions in inches (and mm)

### OPERATING CONDITIONS

#### PRODUCTION (LBS) 60Hz

Voltage	Frequency	Pressure	IQF 900 AIR COOLED					IQF 900 WATER COOLED				
			50° 10°	60° 15°	70° 21°	86° 30°	50° 10°	60° 15°	70° 21°	86° 30°		
±10% V	60 Hz	14.5 psi (1 bar) / 87 psi (6 bar)	904	860	728	617	-	-	-	-		
50°F/109°F			860	818	699	586	-	-	-	-		
41°F/100°F			833	776	664	545	-	-	-	-		
			761	728	635	498	-	-	-	-		

MODELS	Temp. Ev. (°F)	ASHRAE CONDITIONS (BTU/h)	(W)	(W) 109°F	(AWG/mm²)	(n.)	FUSE	100lbs 90°F / 70°F (Kwh/100 lbs)	gal 100lbs (l/h)	HEAT REJECTED (BTU/h)	(W)	(lbs)	(lbs)
IQ F 900 A	5°	12,325	3,612	1,480	16/1.5	3	20	5.9	11.9 12.5	6,190	1,814	185	205
IQ F 900 W	-	-	-	-	-	-	-	-	-	-	-	-	-



**3 YEARS WARRANTY PARTS & LABOR**



ITV Ice Makers, Inc.  
9550 Satellite Blvd, Suite 100  
Orlando, FL 32837  
Phone: 1 407 826 1860 | Fax: 1 407 826 1861  
Toll Free: 1 888 488 1423  
sales@itvice.com | www.itvice.com

SERVICE  
service@itvice.com  
Skype: service@itvice.com  
PHONE: +1 888 488 1423  
FROM 8AM TO 5PM EST

**2 ADDITIONAL YEARS ON COMPRESSOR & EVAPORATOR**  
Read our warranty policy to know more about limitations and exclusions

Intertek

